

PRELIMINARY NOT FOR CONSTRUCTION

THIS PLAN HAS BEEN PREPARED FOR GENERAL LAYOUT DISCUSSION PURPOSES ONLY AND IS BASED ON LIMITED DUE DILIGENCE AVAILABLE AT THE TIME OF PREPARATION

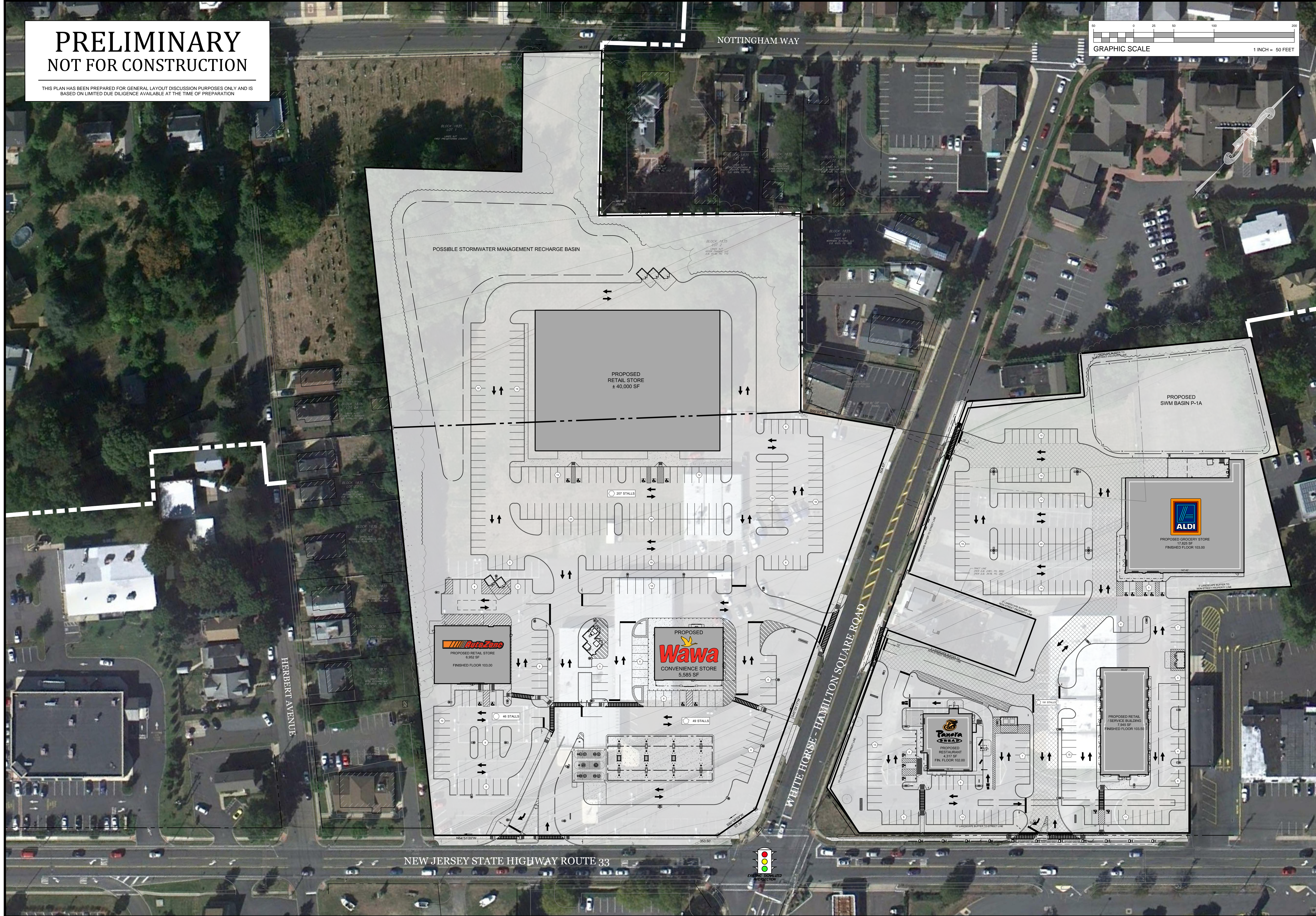
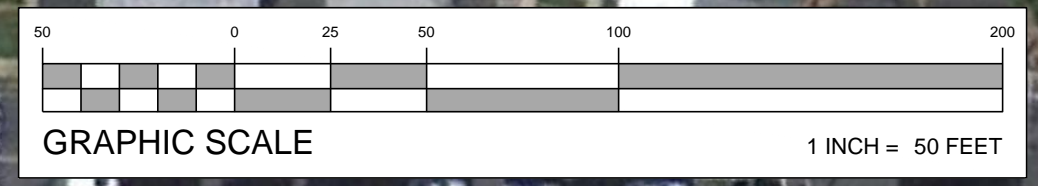

PROJECT NO.	120072
DRAWN BY	B. MEGUST
CHECKED BY	K. M. RUTT
DATE	12/07/15
CAD ID #	120072_OAC-4
PROJECT	DELCO DEVELOPMENT PROPOSED RETAIL DEVELOPMENT
LOCATION	HAMILTON TOWNSHIP MERCER COUNTY, NEW JERSEY
TITLE	OVERALL CONCEPT PLAN
SCALE	(H) AS NOTED (V) 1" = 50'
DATE	2015.02.04
SHEET	CPT
REV. No.	4

REVISION	DATE	BY
04	2016.04.20	H.K.
03	2016.07.13	B.N.
02	2016.04.08	B.N.
01	2016.06.12	B.N.

REVISED PER LATEST LAYOUT AND LEASING	H.K.
REVISED TO ADD BULK TABLE	B.N.
REVISED PER CLIENT COMMENTS	B.N.
REVISED PER CLIENT COMMENTS	B.N.
COMBILT	BY

K. MATTHEW RUTT, P.E.

PENNSYLVANIA LICENSE NO. 07343
NEW JERSEY LICENSE NO. 4262

NOT FOR CONSTRUCTION

LANDCORE
Engineering Consultants, P.C.

100 OVERLOOK CENTER
PITTSBURGH, PA 15222
PHONE: 412.588.8888

LANCASTER, PA 17601
PHONE: 717.252.9854